

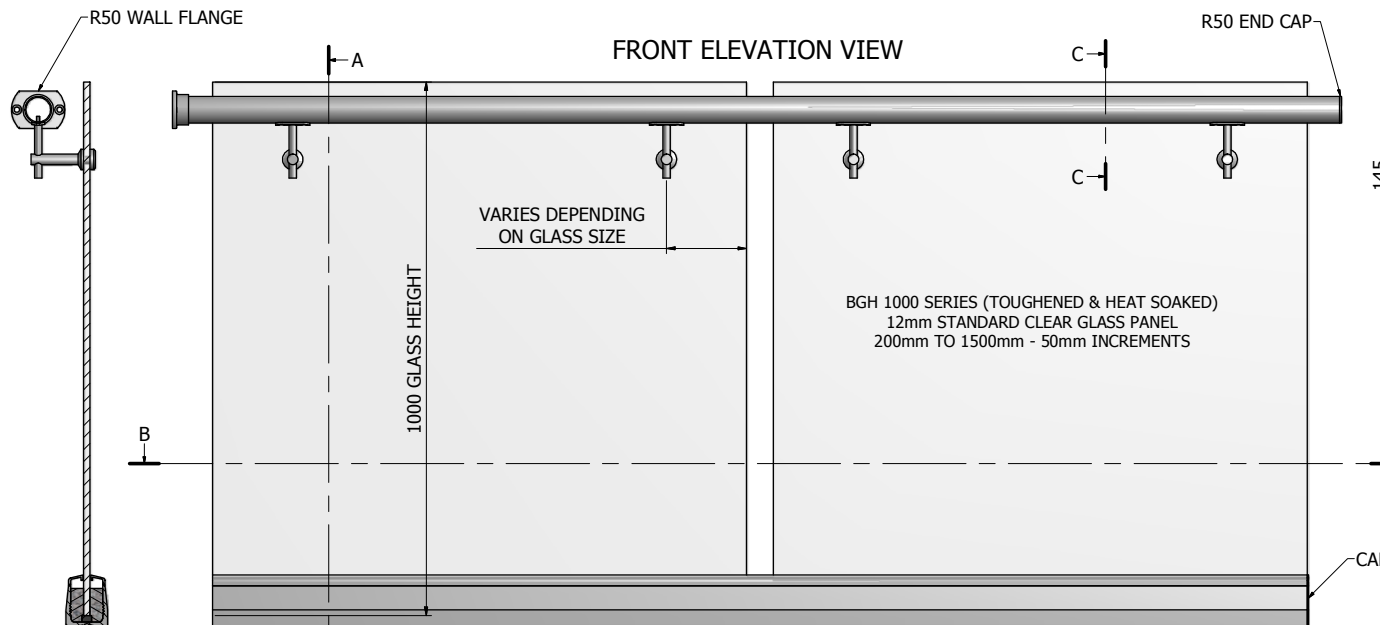

CHANNEL SERIES—SIDE FIX HAND RAIL
BALUSTRADE SYSTEM
INSTALLATION GUIDE

PRODUCT CODE: CHH-SFH

FRONT ELEVATION VIEW



SECTION VIEW A-A

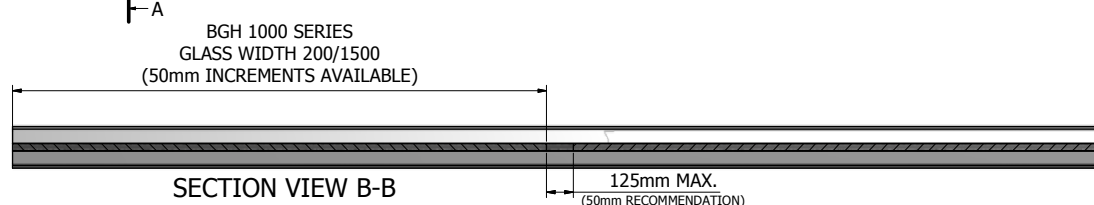

CHANNEL MOUNTING DETAILS

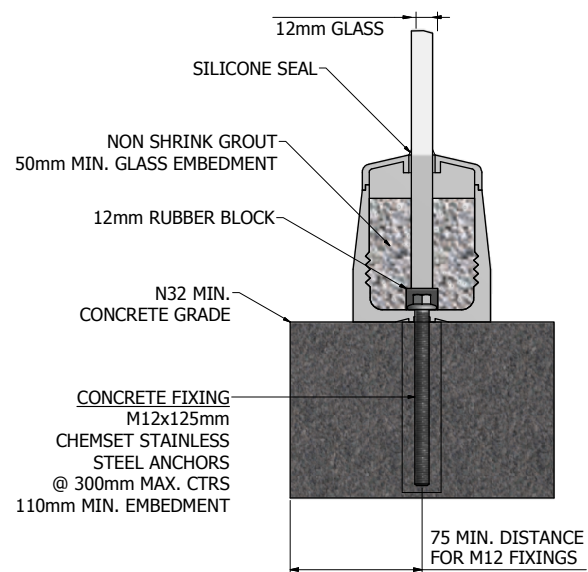

PRODUCT CODE:
CHH-SFH

PRODUCT TYPE:
CHANNEL SERIES - SIDE FIX HANDRAIL

AVAILABLE FINISHES:
- SATIN
- POLISHED

AUSTRALIAN STANDARDS:
REGULATION No. AS2208 - A GRADE TOUGHENED GLASS
COMPLIES TO AS1170.1-2002 SUBSECTION 3.6 BARRIERS
TABLE 3.3 - MINIMUM IMPOSED ACTIONS FOR BARRIERS
TESTED AT 750 N m

GLASS:
BGH 1000 SERIES
12mm CLEAR TOUGHENED
WIDTHS AVAILABLE FROM 200mm TO 1500mm
(IN 50mm INCREMENTS)

HANDRAIL:
- TSR-50 RAIL

CHANNEL
- CH 93 - ALUMINIUM CHANNEL & TOP GLAZING BEADS

RECOMMENDED BASE FIXINGS
- CHANNEL - ON CONCRETE
M12 x 125mm STAINLESS ALLTHREAD & NUT
CHEMSET CHEMICAL ANCHOR

frameless
direct
architectural glass and hardware

21 ENCORE AVENUE, SOMERTON, VICTORIA AUSTRALIA 3062

WEBSITE: www.framelessdirect.com.au
EMAIL: sales@framelessdirect.com.au

TEL: 03 9303 9008
FAX: 03 8339 2425

CH-93

HEAVY DUTY ALUMINIUM GLAZING CHANNEL
INCLUDES 2 x TOP GLAZING BEADS
AVAILABLE IN 3000mm & 6000mm LENGTHS

AVAILABLE FINISH: POWDERCOATED BRIGHT SILVER
OR MILL FINISH ALUMINIUM

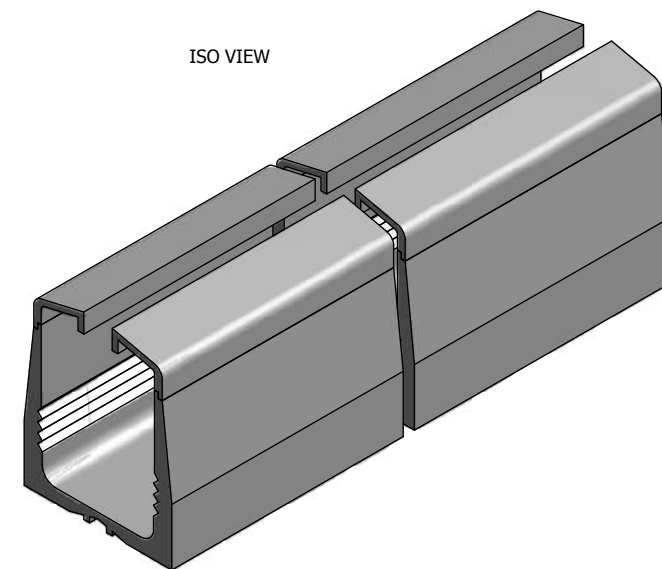
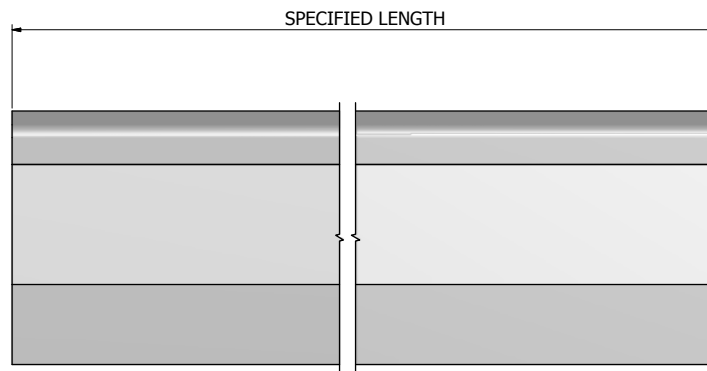
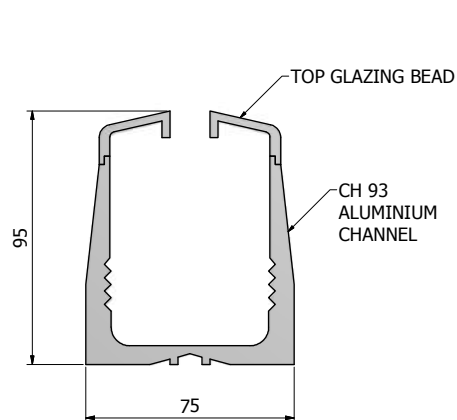

ISO VIEW

CHEC

GLAZING CHANNEL END CAP

2mm LASER CUT ALUMINIUM FLAT SHEET

AVAILABLE FINISHES:
POWDERCOATED BRIGHT SILVER
MILL FINISH ALUMINIUM

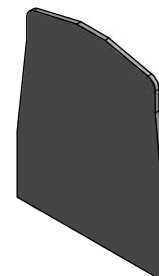
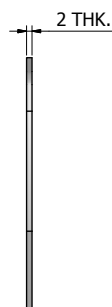
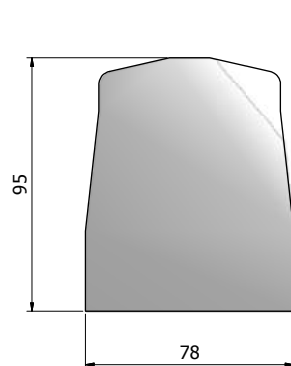

ISO VIEW

21 ENCORE AVENUE, SOMERTON, VICTORIA AUSTRALIA 3062

WEBSITE: www.framelessdirect.com.au TEL: 03 9303 9008
EMAIL: sales@framelessdirect.com.au FAX: 03 8339 2425

frameless
direct
architectural glass and hardware



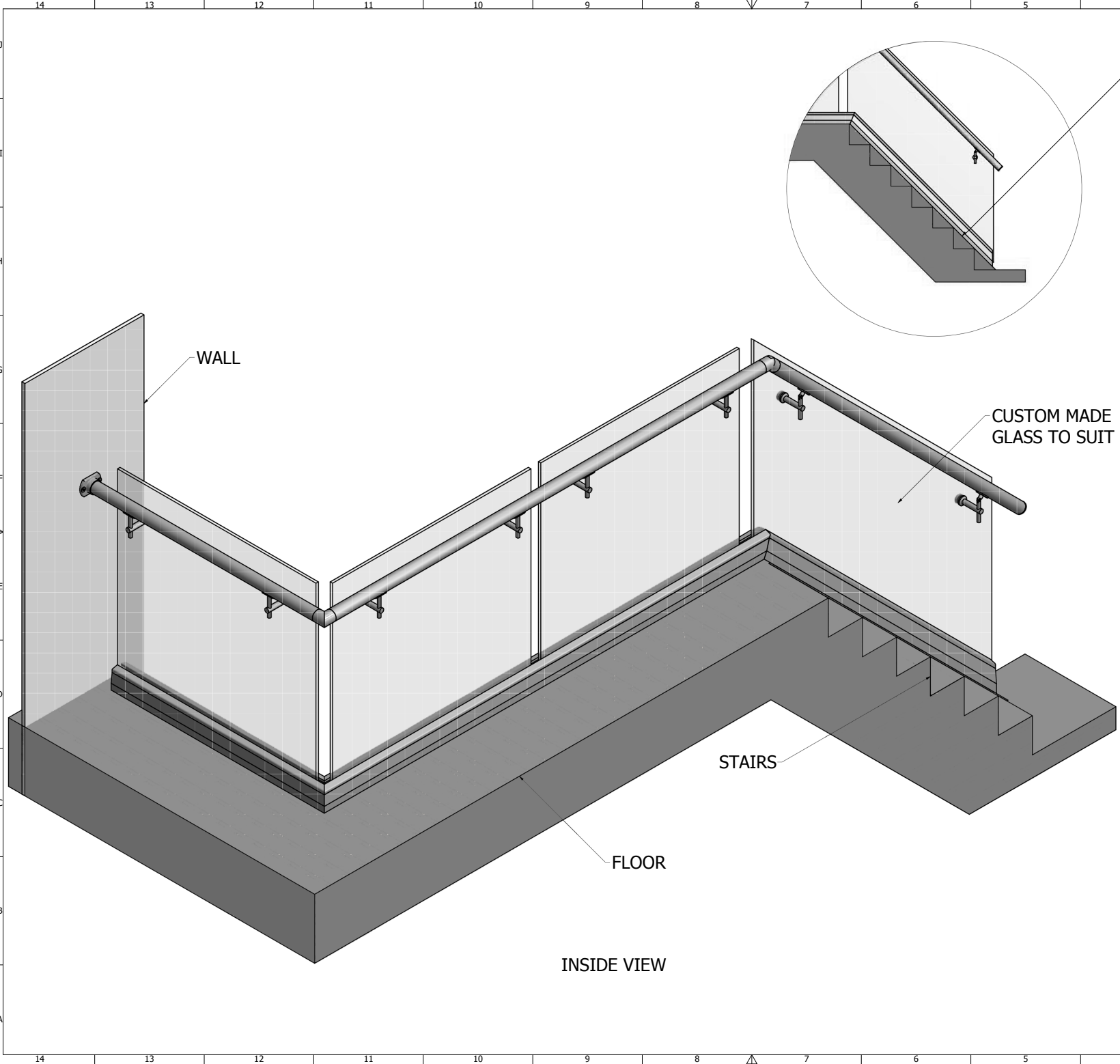

CHANNEL TO BE MOUNTED
ON TOP OF STRINGER
WHEN FITTING TO STAIRS

PRODUCT CODE:
CHH-SFH

PRODUCT TYPE:
CHANNEL SERIES - SIDE FIX HANDRAIL

AVAILABLE FINISHES:
- SATIN
- POLISHED

AUSTRALIAN STANDARDS:
REGULATION No. AS2208 - A GRADE TOUGHENED GLASS
COMPLIES TO AS1170.1-2002 SUBSECTION 3.6 BARRIERS
TABLE 3.3 - MINIMUM IMPOSED ACTIONS FOR BARRIERS
TESTED AT 750 N m

GLASS:
BGH 1000 SERIES
12mm CLEAR TOUGHENED
WIDTHS AVAILABLE FROM 200mm TO 1500mm
(IN 50mm INCREMENTS)

HANDRAIL:
- TSR-50 RAIL

CHANNEL
- CH 93 - ALUMINIUM CHANNEL & TOP GLAZING BEADS

RECOMMENDED BASE FIXINGS
- CHANNEL - ON CONCRETE
M12 x 125mm STAINLESS ALLTHREAD & NUT
CHEMSET CHEMICAL ANCHOR



21 ENCORE AVENUE, SOMERTON, VICTORIA AUSTRALIA 3062

WEBSITE: www.framelessdirect.com.au
EMAIL: sales@framelessdirect.com.au

TEL: 03 9303 9008
FAX: 03 8339 2425

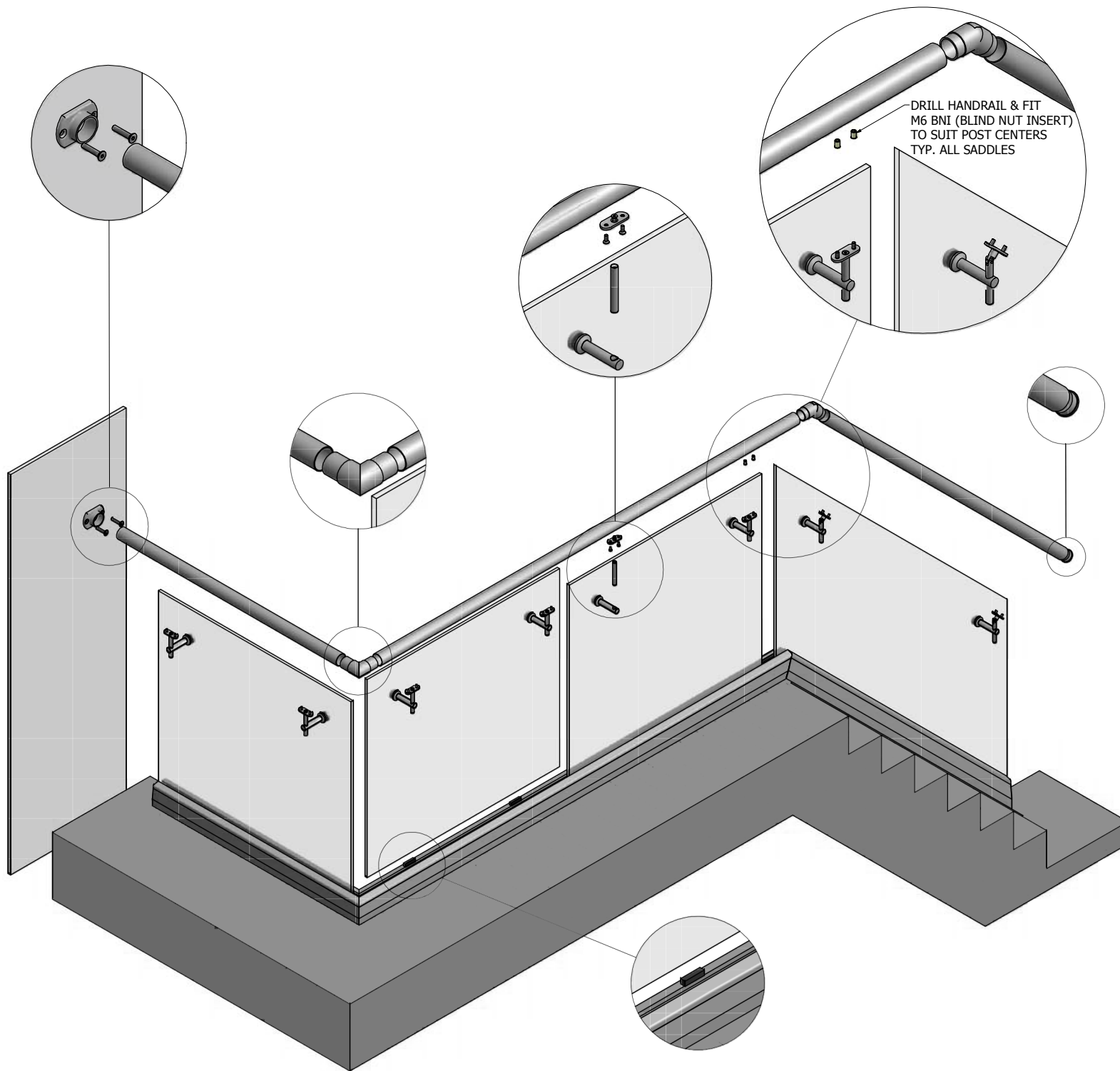

PRODUCT CODE:
CHH-SFH

PRODUCT TYPE:
CHANNEL SERIES - SIDE FIX HANDRAIL

AVAILABLE FINISHES:
- SATIN
- POLISHED

AUSTRALIAN STANDARDS:
REGULATION No. AS2208 - A GRADE TOUGHENED GLASS
COMPLIES TO AS1170.1-2002 SUBSECTION 3.6 BARRIERS
TABLE 3.3 - MINIMUM IMPOSED ACTIONS FOR BARRIERS
TESTED AT 750 N m

GLASS:
BGH 1000 SERIES
12mm CLEAR TOUGHENED
WIDTHS AVAILABLE FROM 200mm TO 1500mm
(IN 50mm INCREMENTS)

HANDRAIL:
- TSR-50 RAIL

CHANNEL
- CH 93 - ALUMINIUM CHANNEL & TOP GLAZING BEADS

RECOMMENDED BASE FIXINGS
- CHANNEL - ON CONCRETE
M12 x 125mm STAINLESS ALLTHREAD & NUT
CHEMSET CHEMICAL ANCHOR

frameless
direct
architectural glass and hardware **f**

21 ENCORE AVENUE, SOMERTON, VICTORIA AUSTRALIA 3062

WEBSITE: www.framelessdirect.com.au
EMAIL: sales@framelessdirect.com.au

TEL: 03 9303 9008
FAX: 03 8339 2425

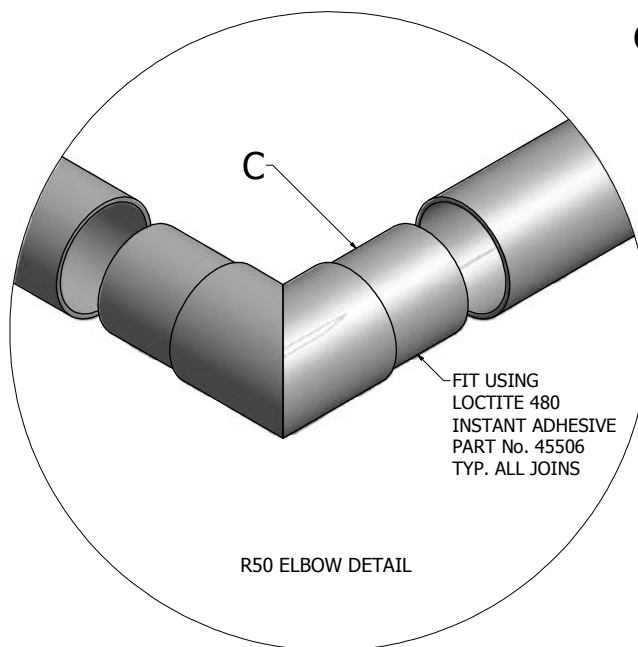
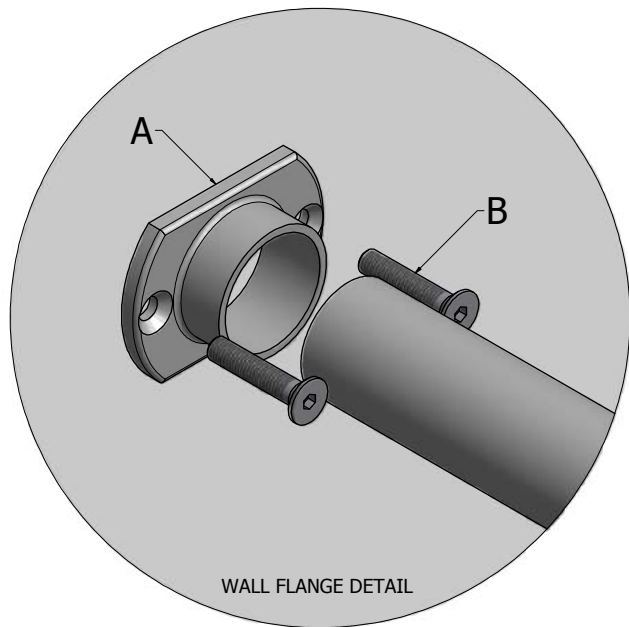

CHANNEL SERIES SIDE FIX HANDRAIL R50 HAND RAIL OPTIONS

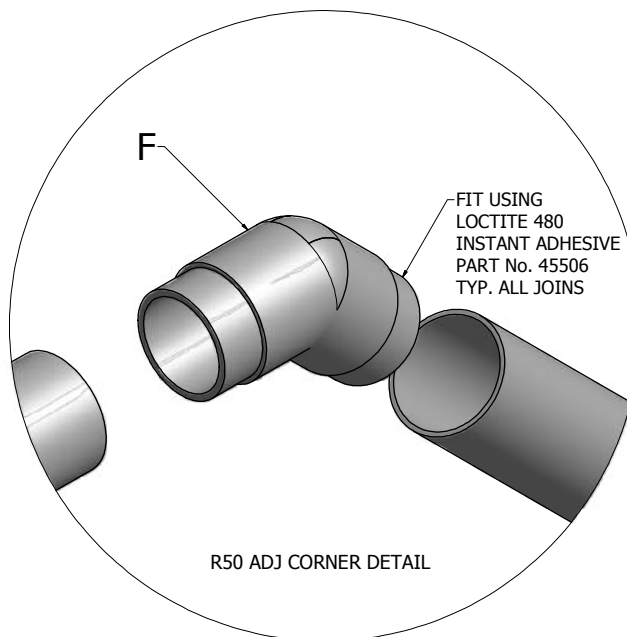
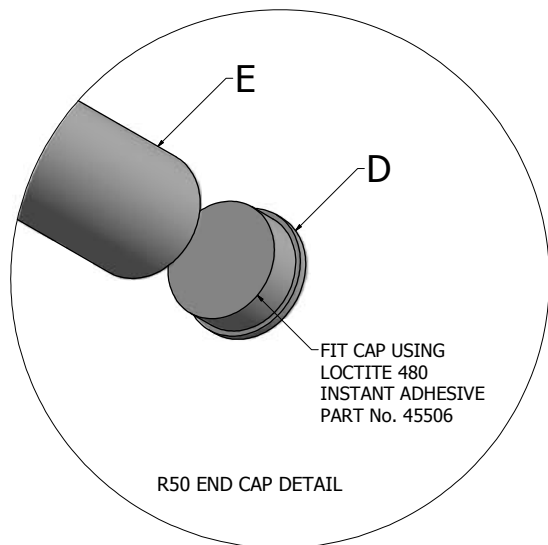

ITEM LIST

- A - R50 WALL FLANGE
- B - WALL / POST FIXING SCREW
- C - R50 ELBOW
- D - R50 END CAP
- E - TSR-50 - RAIL
- F - R50 ADJ JOINER

frameless
direct
architectural glass and hardware

21 ENCORE AVENUE, SOMERTON, VICTORIA AUSTRALIA 3062

WEBSITE: www.framelessdirect.com.au
EMAIL: sales@framelessdirect.com.au

TEL: 03 9303 9008
FAX: 03 8339 2425

CHANNEL SERIES HAND RAIL & CHANNEL DETAILS

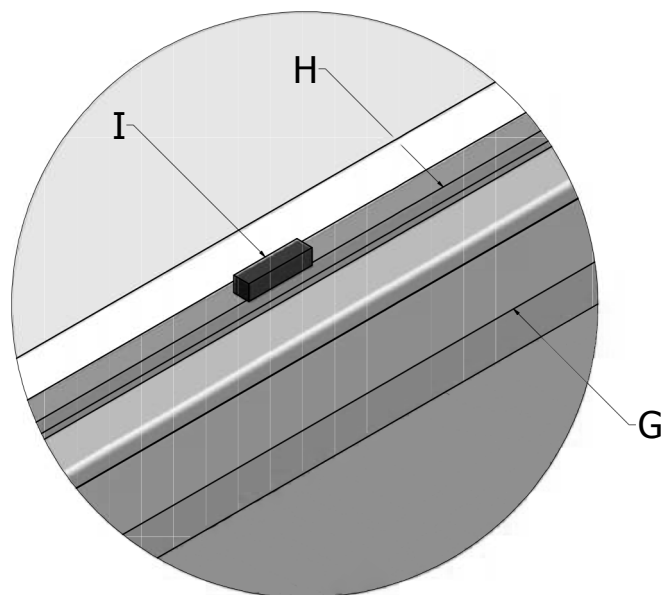
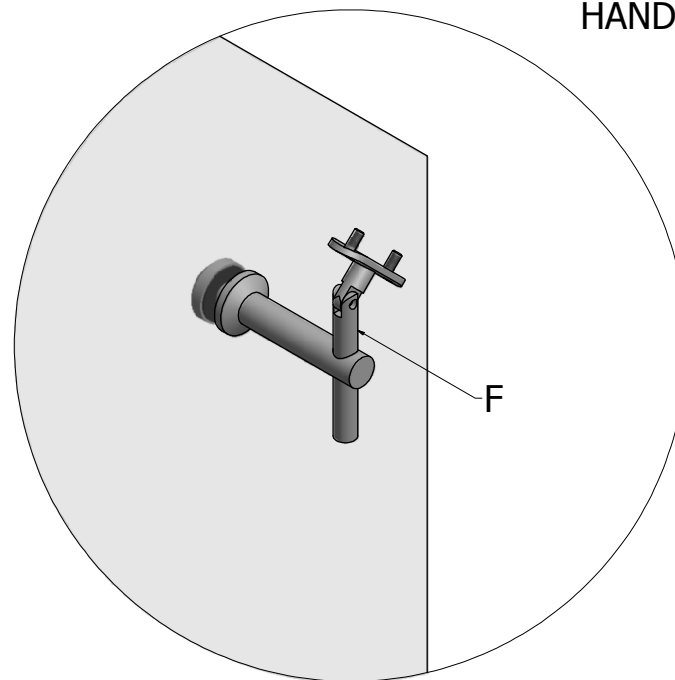
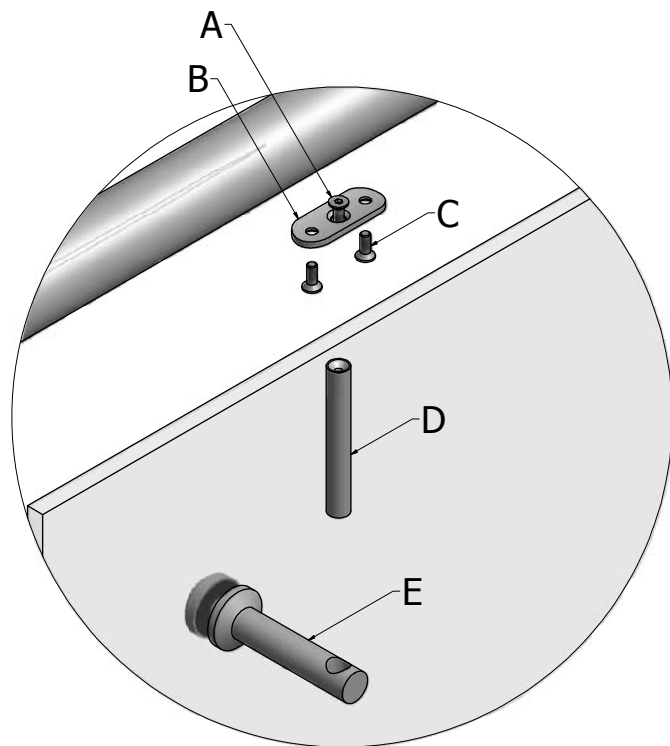

ITEM LIST

- A - M6 x 16 COUNTERSUNK SETSCREW
- B - SSA-12 COLLAR
- C - M6 x 16 COUNTERSUNK SETSCREW
- D - HBF-04 SADDLE POST
- E - HBF-04 GLASS SPIGOT
- F - HBF-04 SADDLE POST - ADJUSTABLE
- G - CH-93 - ALUMINIUM CHANNEL
- H - CH-93 - GLAZING BEAD
- I - 12mm RUBBER SETTING BLOCK

frameless
direct
architectural glass and hardware

21 ENCORE AVENUE, SOMERTON, VICTORIA AUSTRALIA 3062

WEBSITE: www.framelessdirect.com.au
EMAIL: sales@framelessdirect.com.au

TEL: 03 9303 9008
FAX: 03 8339 2425

BGH 1000 - 200mm TO 1500mm
INCREMENTS OF 50mm

A

B

145

Ø16 TYP.

12

ISO VIEW

HOLE DIMENSIONS

- GLASS WIDTH 200mm UPTO 450mm DIM A = 1 HOLE ONLY IN THE CENTER
- GLASS WIDTH 500mm UPTO 1000mm DIM A & DIM B = 150mm
- GLASS WIDTH 1050mm UPTO 1500mm DIM A & DIM B = 200mm

PRODUCT CODE:
BGH 1000

PRODUCT TYPE:
BALUSTRADE GLASS PANEL 1000mm

TECHNICAL DETAILS:
12mm TOUGHENED CLEAR GLASS
2mm RADIUS CORNERS
POLISHED EDGES

AUSTRALIAN STANDARDS:
REGULATION No. AS2208 - A GRADE TOUGHENED GLASS

frameless
direct
architectural glass and hardware



21 ENCORE AVENUE, SOMERTON, VICTORIA AUSTRALIA 3062

WEBSITE: www.framelessdirect.com.au
EMAIL: sales@framelessdirect.com.au

TEL: 03 9303 9008
FAX: 03 8339 2425